

EXPLANATION

- B-5 Soil boring location with identifier.
- MW-A (B-11) Monitoring well location with identifier and boring number.
- Fence line.
- AST bermed area.
- Property line.
- Aboveground Storage Tank - removed 2003.
- Failed AST - removed April 2001.
- Underground Storage Tank - removed 1991.
- Extent of excavation (April 2001).
- Extent of excavation (May 2003).
- SW-N2 Excavation sidewall or floor soil sample location with identifier.
- Estimated extent of soil contamination above compound specific NR 720 generic RCLs.

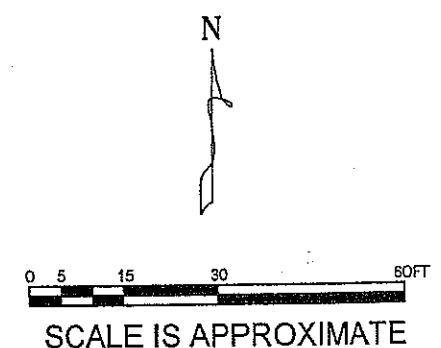

FILE: J:\FIGURES\65575\SOILCTM-postex2003.DWG [SOIL-0906]
DATE: 10/10/2006 DRAWN BY: MLW, DAN CHECKED BY: SER
SOURCE: FIELD NOTES
= Geoprobe Boring Location (METCO)

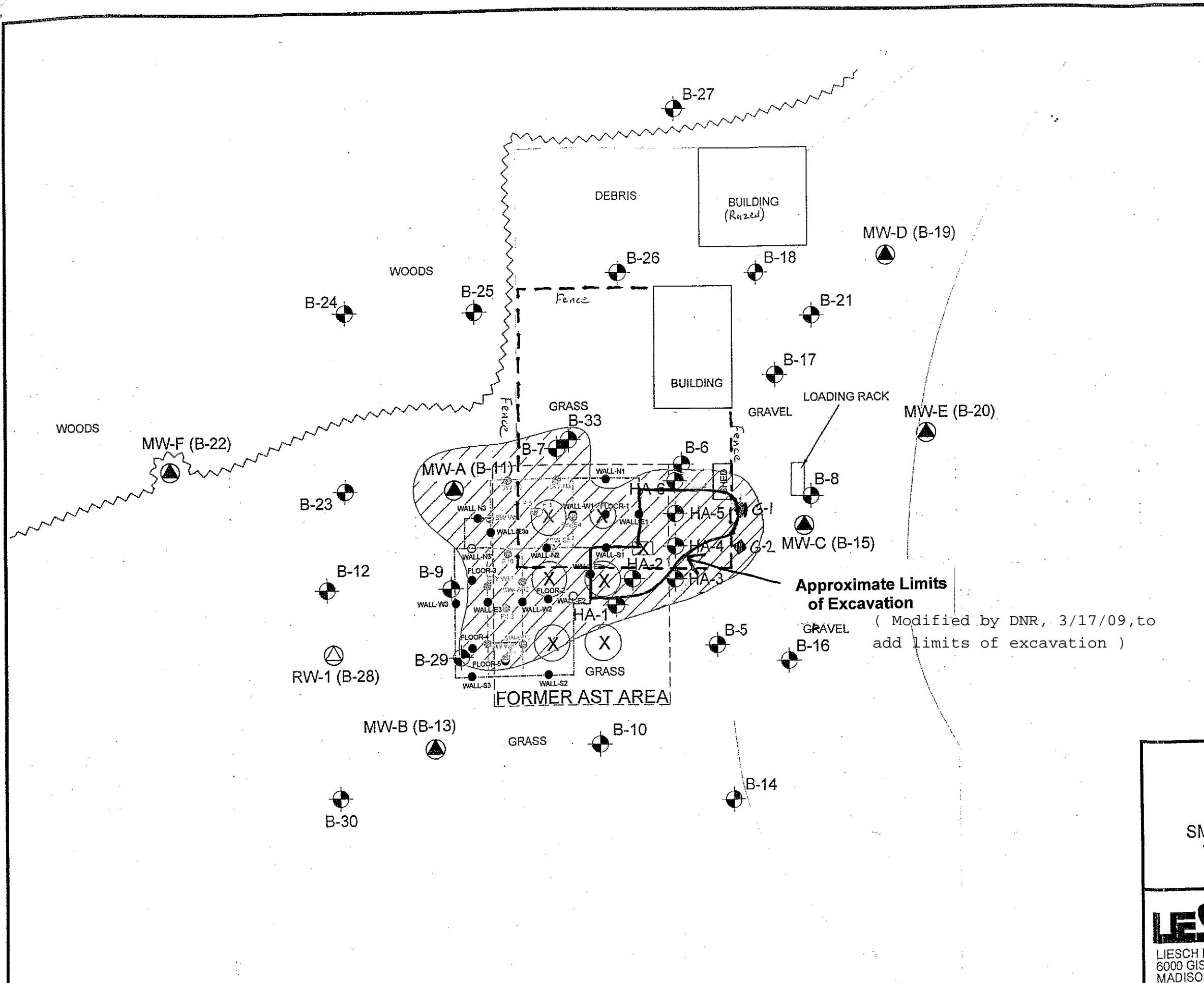

AERIAL EXTENT OF SOIL CONTAMINATION
 December 2008
SMITH PETROLEUM BULK PLANT
 110 NORTH MARKET STREET
 DARIEN, WISCONSIN

LIESCH
 LIESCH ENVIRONMENTAL SERVICES, INC.
 6000 GISHOLT DRIVE, SUITE 203
 MADISON, WI 53713

FIGURE
2

Modified by METCO, ED 12/19/08