

FIELD NOTES:
 1.) BASE MAP DEVELOPED FROM THE "M.S. RECORD/
 SEWERAGE WELL LOCATION PLAN" FOR THE
 ELECTRICITY BY THE CITY (2/1/76).

GILES ENGINEERING ASSOCIATES, INC.
 200 W. WASHINGTON STREET, SUITE 211
 MILWAUKEE, WI 53202 (414) 344-1110

FIGURE 1
 SITE PLAN
 WATER SALES-LAKE GENEVA WALK PLANT
 1500 CAREY STREET
 LAKE GENEVA, WISCONSIN

REVISED	DRAWN	SCALE	DATE	BY
ETB	JFK	1"=40'	06-20-08	03-14-07
PROJECT NO. 12-080000			JOB NO. 120800000	



FIELD LOCATIONS:

MW-17	GROUNDWATER MONITORING WELL (COMPLETED BY OTHERS)
MW-1	GROUNDWATER MONITORING WELL (COMPLETED BY OTHERS)
▲	TEMPORARY MONITORING POINT IN POWER POLE SECTION - SEE PLAN

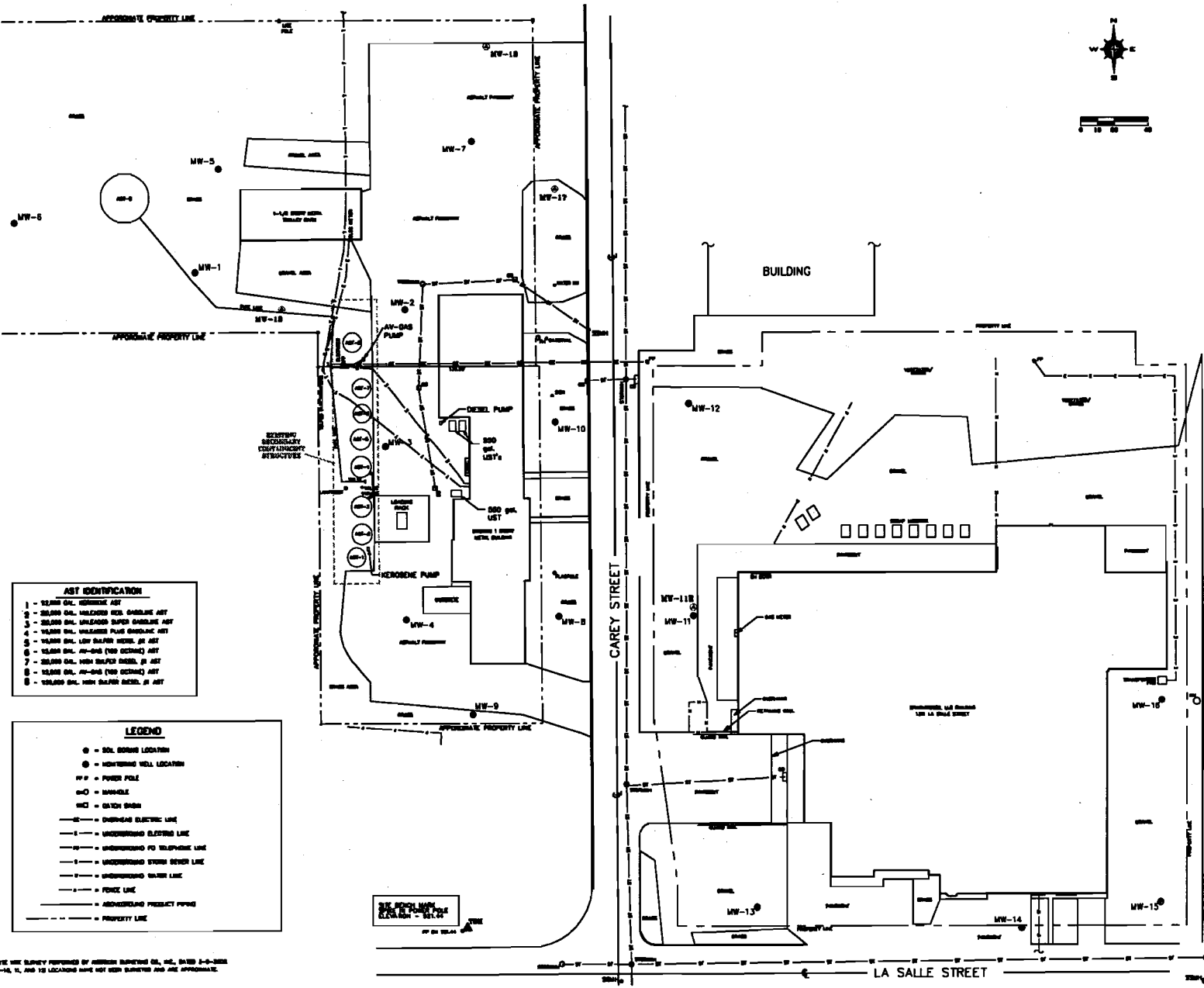

- AST IDENTIFICATION**
- 1 - 12" DI. WIREMESH AST
 - 2 - 12" DI. WELDED WIRE BARREL AST
 - 3 - 12" DI. UNWELDED WIRE BARREL AST
 - 4 - 12" DI. WELDED PLUS BARREL AST
 - 5 - 12" DI. WELDED PLUS BARREL AST
 - 6 - 12" DI. WELDED PLUS BARREL AST
 - 7 - 12" DI. WELDED PLUS BARREL AST
 - 8 - 12" DI. WELDED PLUS BARREL AST
 - 9 - 12" DI. WELDED PLUS BARREL AST
 - 10 - 12" DI. WELDED PLUS BARREL AST

- LEGEND**
- - WELL BORE LOCATION
 - ⊙ - MONITORING WELL LOCATION
 - ⊕ - POWER POLE
 - ⊖ - MANHOLE
 - ⊗ - GATE VALVE
 - OVERHEAD ELECTRIC LINE
 - UNDERGROUND ELECTRIC LINE
 - UNDERGROUND TELEPHONE LINE
 - UNDERGROUND WATER SERVICE LINE
 - UNDERGROUND WATER LINE
 - FENCE LINE
 - UNDERGROUND PRODUCT PIPE
 - PROPERTY LINE

NOTES:
 1. THE MAP FROM THE SITE WAS PREPARED BY GEORGE BARNETT CO., INC. DATE 1-2-2008
 2. MONITORING WELLS MW-14, 15, AND 16 LOCATIONS HAVE NOT BEEN DETERMINED AND ARE APPROXIMATE.